

BARRACLUFF PARK AND PLAYGROUND

Project Update: Multi-play equipment

The multi-play equipment is the central piece in the playground, it is intended for use by a wide age range with graduated challenges and rewards built into the equipment. The equipment will be inclusive and aim to allow users of all abilities to access large portions of the equipment and interact with other users. The equipment is also designed to allow parents or carers easier access to easily be involved in play.

Complimenting the central piece will be a triple swing set, see saw, rockers, spinner, and a discrete cubby with slide (for toddlers away from the bigger kids).

The Playground will also have a graduated nature play section with balance beams, steppers, and boulders of varying difficulty.



3m high platform

Overlooking the whole playspace and up in the canopy of the adjacent pine trees, the highest platform exits to the ground by an enclosed spiral slide.

2m high platform

Overlooking the hardcourt adjacent to the playground, access to this platform is slightly harder than the first, through the use of a rope net from ground level and panel ladders from the first platform.

Interactive and sensory items will be underneath this platform, including a warped mirror, talking tubes, and rotating cubes.

1m high platform

Wide easier access platform with a double width slide, sliding pole, interactive panels, and ladder access. Sensory equipment will also be installed at this level (currently shown on higher platform).

Transfer platforms

Designed to allow easier access to the play equipment for all users of all abilities.

Note:

Design is the latest revision as of June 17, modifications are expected to increase play experience and interaction between platforms.

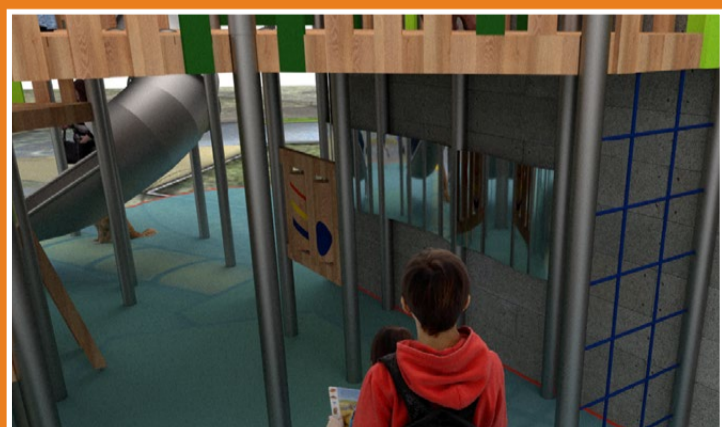

Sensory mirrors and interactive panels under the second platform.

The designers are working on integrating windows through the platform for interaction between those on the second platform and improving visibility underneath.



Double width slide from the first platform back to ground level. Rotating blocks, speaking tubes and cubby spaces are easily accessible from both ground and the first platform.



The second platform has speaking tubes connected to ground and the first platform. A telescope is available for surveying the play ground, or you could watch the ball game on the otherside.

The xylophone and spinning wheel will be relocated to the first platform.

For more information, please contact Andrew Chau at openspace@waverley.nsw.gov.au