

4.3 Heritage Significant Trees

Trees with identified heritage values can be listed in Schedule 5 of the Waverley LEP. Listing can include individual trees or groups of trees, such as those that form part of a landscape or garden of a listed heritage property. Such trees are assessed for their significance using the Heritage Office criteria rather than for their landscape qualities. Waverley Council can also lists such items on its Significant Tree Register (below). They are protected by the Waverley Development Control Plan - Part B5 Tree Preservation. This tree register defines significant trees as “those trees that make a major contribution to the everyday landscape and are therefore of special value to the community”. At present there are 52 trees on the register. It is proposed that trees on one sites be included on Schedule 5 as trees with heritage significance.

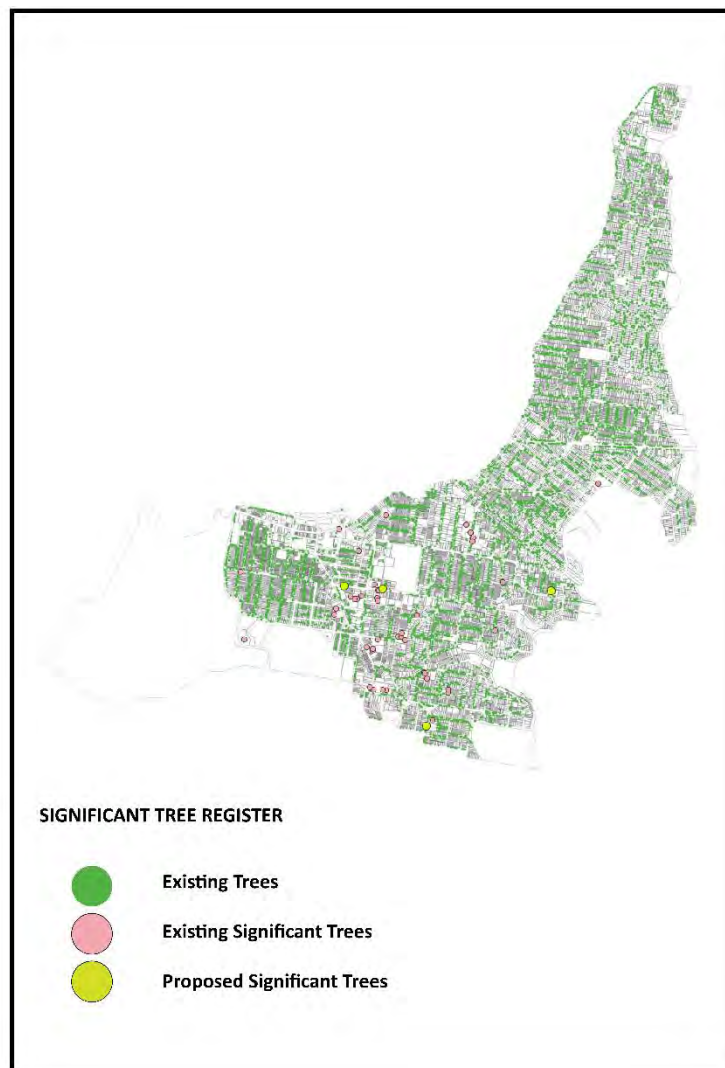

Significant Tree Register

The following trees have been assessed as also having Heritage significance:

No	Address	Description
1	Rowland St, Bondi	<p><i>Phoenix canariensis</i></p> <p>Significance: Historic, aesthetic</p> <p>Avenue of palm trees linked to the earliest iteration of the Bondi tramline and its terminus in Rowland St. The tramline assisted the early development of Bondi as a tourist destination in the 19th century, before sea bathing, with attractions including the Bondi Aquarium and, later, Wonderland City. The tram detour off Bondi Rd via Fletcher St and Rowland St is reflected in the curved elements of the buildings along its route. The detour was required because of the steepness of Bondi Rd at its lowest point.</p>