

# OPPORTUNITIES AND CONSTRAINTS

## MACPHERSON PARK AND PLAYGROUND

DRAFT CONCEPT DESIGN  
25 OCTOBER 2014

**Pedestrian access** to the park is restricted by wide crossings and traffic flow on Macpherson St and Arden St. Improving access would better connect the park with the shops, Clovelly School and users to the north and west.

**Park corner** has long views to the ocean but feels exposed to traffic and cluttered with signage, which blocks views. Rationalising signage and planting trees would make the park feel bigger.

**Trees on the north edge** are intermittent and restricted by power lines. Supplemental tree planting would help define the park edge and increase shade.

**Steep slope** along north edge restricts pedestrian access into the park and presents an ongoing maintenance hazard.

**Open kick-about area** is useful for informal ball games. Relocating the existing playground out of this area would increase overall park usage.

**Playground** has some active equipment but is run down and has little shade. Relocating the playground amongst existing trees would increase shade cover.

**Large trees** frame the open area, provide shade and give the park a distinct woodland character.

**Traffic** on Arden St generates noise, but also provides surveillance into the park, which discourages anti-social behaviour.

**Footpaths** provide pedestrian access along two sides of the park. A path through the park to the playground would improve access for everyone.





# IDEAS FOR NEW PLAYGROUND

## MACPHERSON PARK AND PLAYGROUND

DRAFT CONCEPT DESIGN  
25 OCTOBER 2014



Mazes can be fun for kids of different ages.



Rigid climbing structures help develop motor abilities and coordination.



Flexible climbing structures require greater balance and are good for older kids.



Lookouts are fun for older kids, especially when combined with other obstacles.



Sculptures can start made up games and encourage imagination and role play.



Shrubs can separate busy and quiet play areas and buffer surrounding uses like roads.



Natural elements provide a range of textures that stimulate the senses.



Rubber surfaces can generate fun undulating shapes and withstand high use.



Flat grass areas are good for ball games, scooters and learning to ride a bike.



Sound tubes and other elements can encourage experimenting with noise



Basket swings are fun for kids of different ages and physical abilities



Slides are always popular in playgrounds with kids of most ages and abilities.



# DRAFT PLAY CONCEPT

The draft concepts shown on this page are a direct response to the site's opportunities and constraints. These ideas will be developed further following community input.

This draft concept relocates the playground amongst existing and new trees, creating a shaded, woodland play experience. Play elements have been selected and sited to encourage use from children of varying ages and abilities.

Materials will be mostly natural (timber and mulch), to compliment the woodland setting, with some bright colours and artificial surfaces to give contrast and ensure the playground withstands regular use.

An open layout will maintain sightlines from adjacent streets and discourage antisocial behaviour, especially at night.

# MACPHERSON PARK AND PLAYGROUND

DRAFT CONCEPT DESIGN  
25 OCTOBER 2014

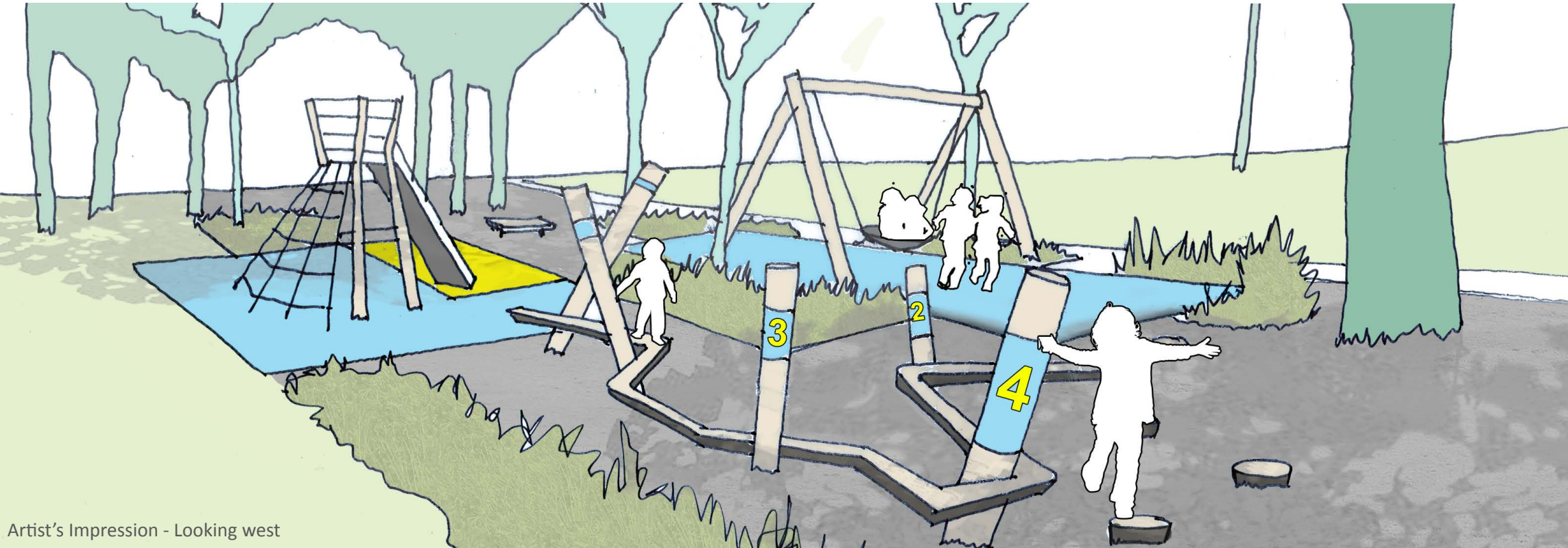

Artist's Impression - Looking west

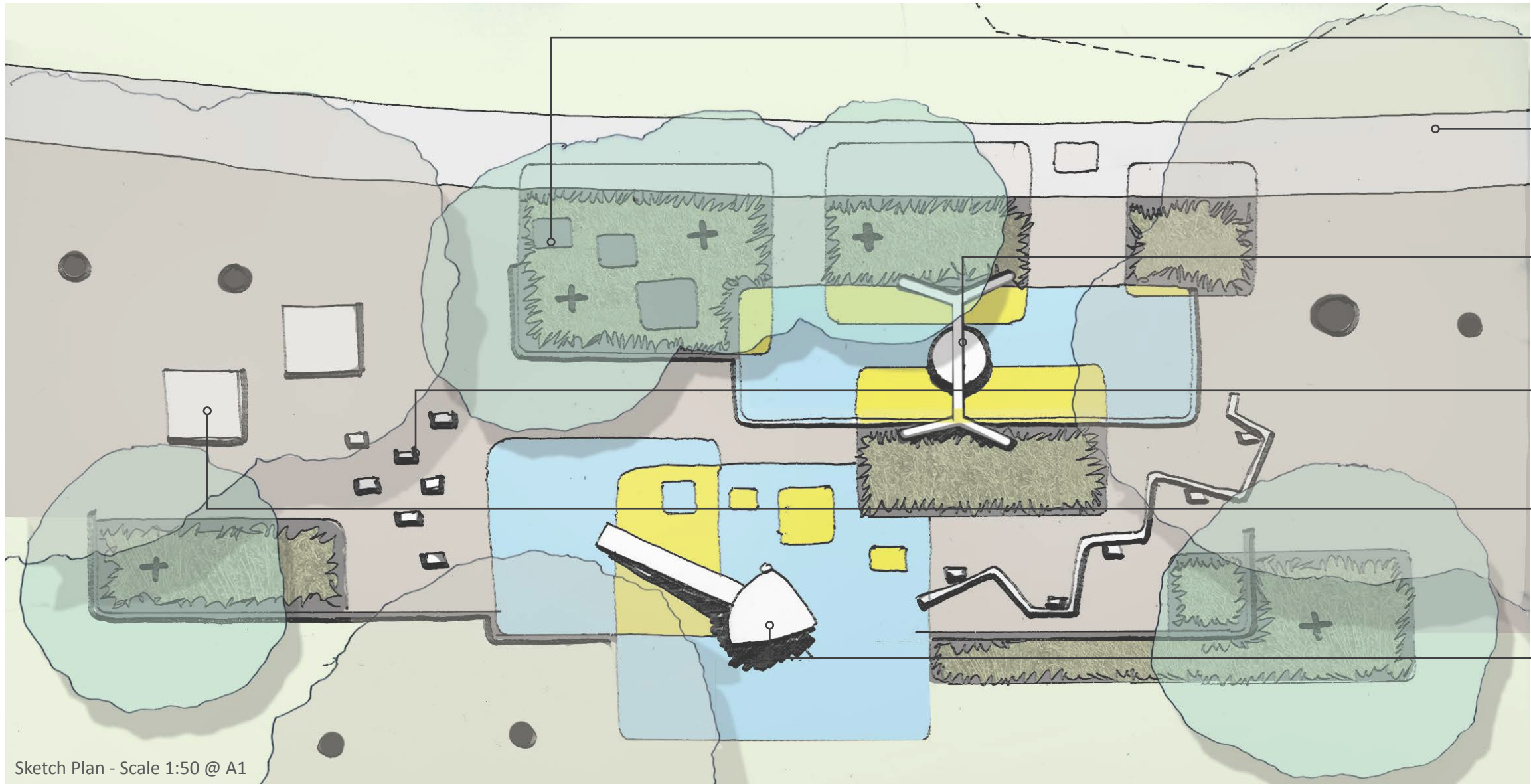

Sketch Plan - Scale 1:50 @ A1

**Tree and shrub planting** defines the edges of the play area, provides shade and keep balls from running away.

**New path** improves access to the playground and can be used as a play element in circuits, by scooters and bikes, and as a hopscotch court.

**Basket swing** located close to path and grass area to make it accessible to wheelchairs and to consolidate active use on one side of the playground.

**Toddler play area** located under existing shade and partially separated from active play areas. Elements could include a maze, sound and nature play elements.

**Seating** located under existing shade trees, close to path and toddler area to encourage hands on play. Seating also separates the playground from Arden St, to buffer children from the road.

**Adventure course** for older kids; including balance beams, stepping stones and a lookout, with a slide.